

BagBoy[®]

BAGBOY.com

VOLT[™]

ELECTRIC CART



FC CE

User Manual

Contents

Packing List	p.3
Specifications	p.4
Unfolding Your Volt	p.5
Folding Your Volt	p.6
Assembling Umbrella Holder	p.7
Retractable Anti-Tip Fourth Wheel	p.7
Front Wheel	p.8
Battery Connection	p.9
Battery Indicator	p.10
Battery Charging	p.11
Operating & Display	p.12-13
Distance Control	p.14
Free Run Control	p.14
Display – Icon Bar	p.15
Display – System Info.	p.15
Display – Warning Info.	p.16
Remote Control	p.17-19
Pairing Your Remote	p.20
FCC Compliance Statement	p.21-22
Battery Care & Safety	p.23-24

For additional assistance,
please contact us at 1-800-955-2269

Warranty information is available at
bagboy.com

Packing List

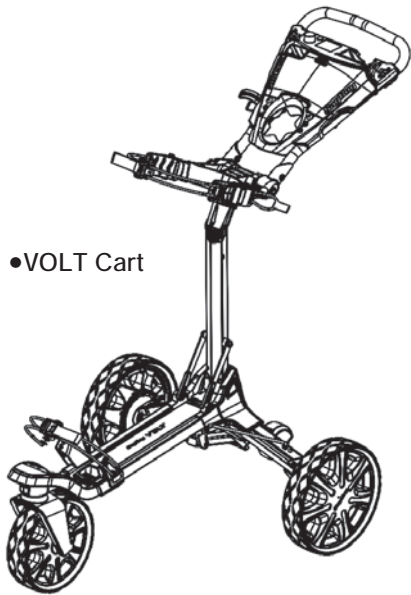

•VOLT Cart

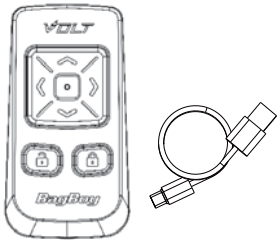

•Remote & USB-C Cable



•Umbrella holder

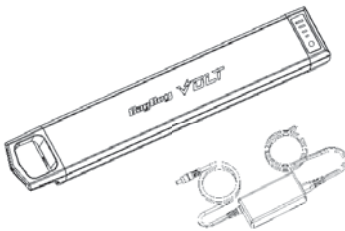

•Cart Battery & Charger
24V Lithium battery



•User Manual

Specifications

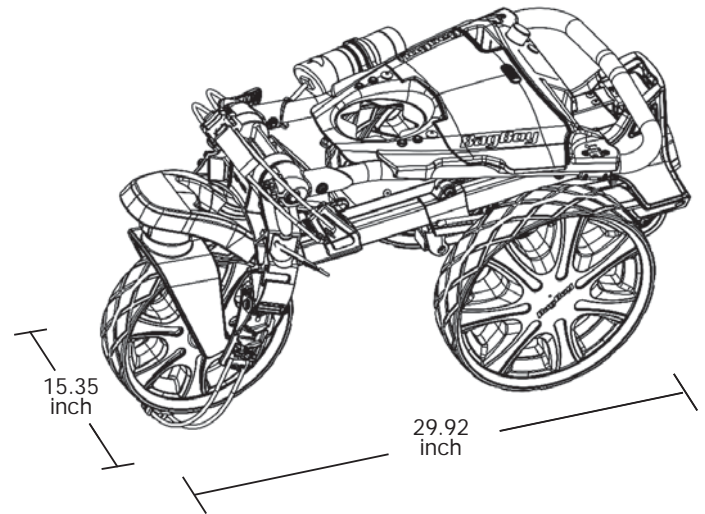

WEIGHT	29.76 lbs (Cart 26.46 lbs + Battery 3.30 lbs)
DIMENSIONS	29.92 inch (L) x 15.35 inch (W) x 15.35 inch (H)
MOTOR	Rated power 2 x 65w
MATERIAL	Aluminum

Unfolding Your Volt

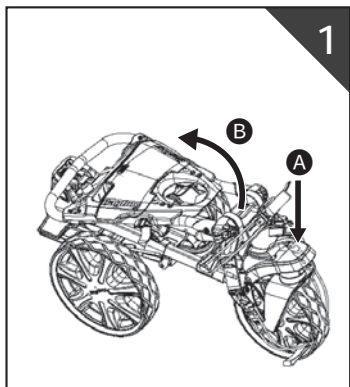

- Press down on the top of the front wheel **A**.
 - Lift the upper bag bracket **B** until the cart "Clicks" open.
 - Open the Handle Fold Lever **C**.
 - Adjust the handle to a comfortable height.
 - Close the Handle Fold Lever to lock the handle in position.

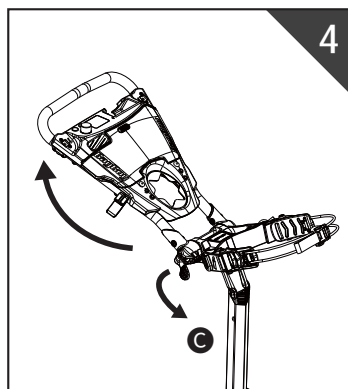
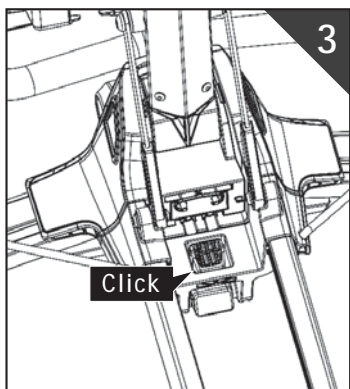
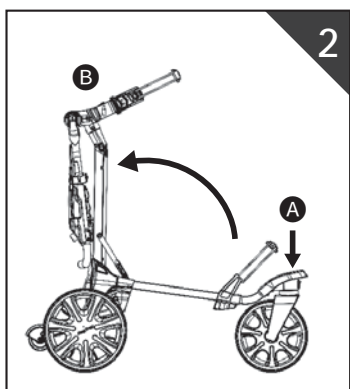

Folding Your Volt

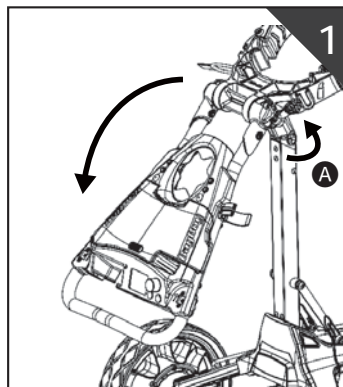

- Open the Handle Fold Lever **A** to release the handle to a closed position.
 - Lift the "Release" lever **B** located below the main pivot point of the cart.
 - Push down on the upper frame **C** at the same time to fold the cart.
 - The remote can be stored in the console.

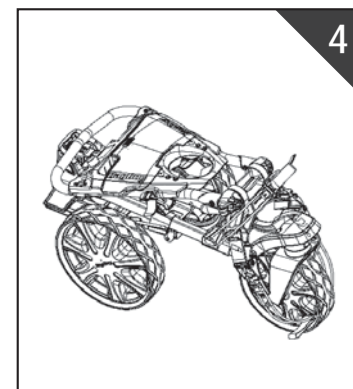
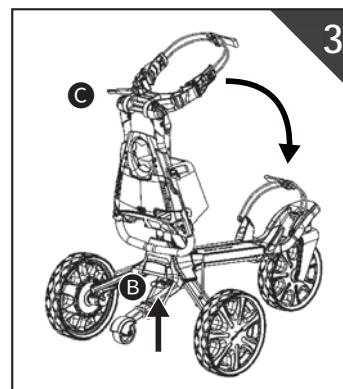
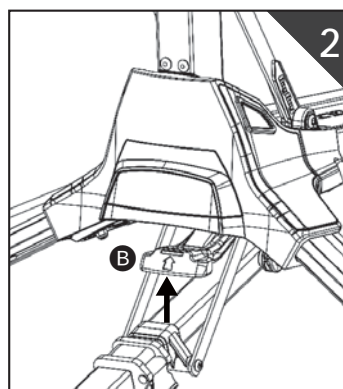

Assembling Umbrella Holder

The umbrella holder can be installed on either side of the handlebar in the area marked with the umbrella symbol.

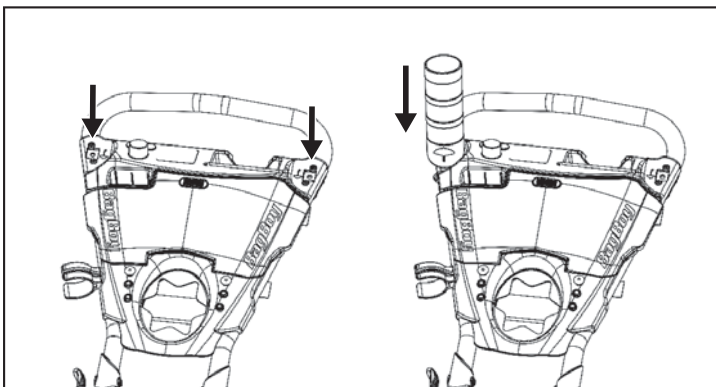

Front Wheel

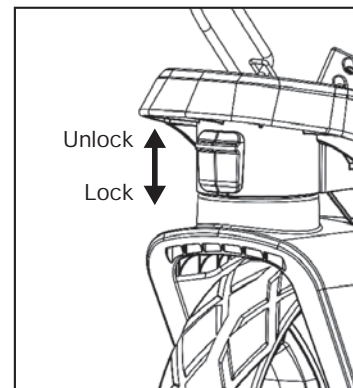
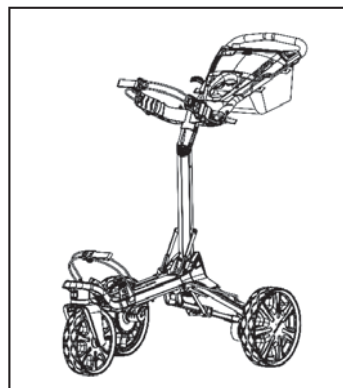

Swivel Lock Out

- There is a slider “Swivel Lock” located at the front of the Wheel Housing.
- This feature will lock when pushing on a side-hill terrain to provide better control of the golf cart without the front swivel
- To lock the front wheel, slide Swivel-Lock down and turn the front wheel forward until the lock clicks into place.

Retractable Anti-Tip Fourth Wheel

The Fourth Wheel is designed to prevent the cart from turning over on steep inclines. To adjust the length of the wheel, just flip the grey quick-release buckle on the right side, then pull the tube to position and close the quick-release buckle.

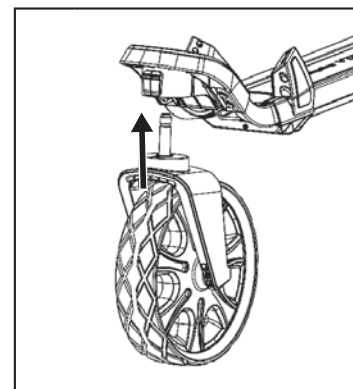
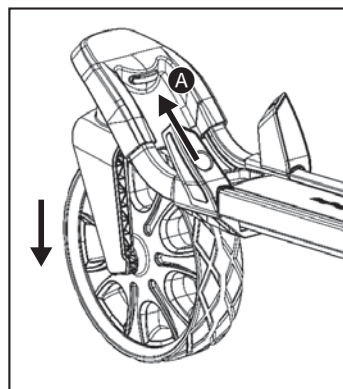
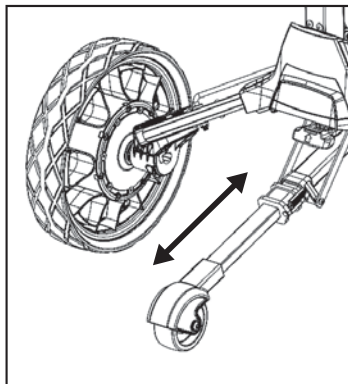
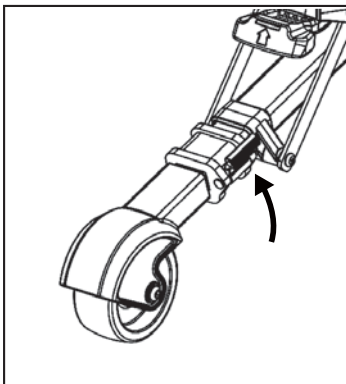

Remove the Front Wheel

To remove the front wheel, press the grey release button **A** located on the inside of the front-wheel housing.

Install the Front Wheel

Insert the wheel pin into the front-wheel base until it “Clicks” into place.

Battery Connection

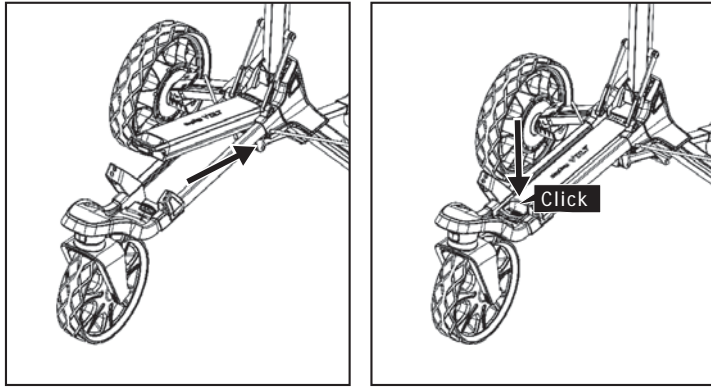

- Hold the battery-handle and connect the bottom of the battery to the position on the cart.
- Press down on the battery-handle until it "Clicks" into place.

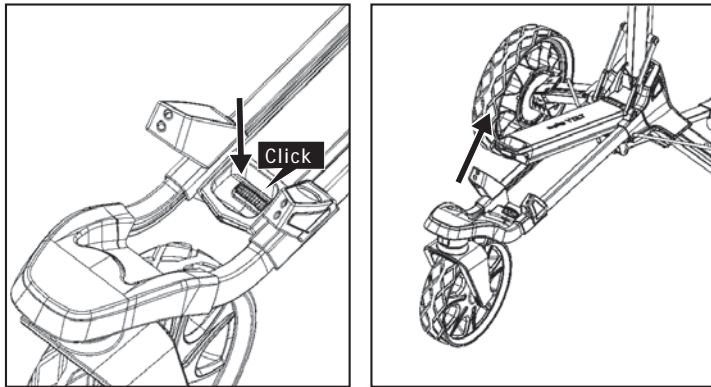

- To remove the battery from the cart, just press down on the grey release button near the handle of the battery on the cart until hearing click.

Battery Indicator

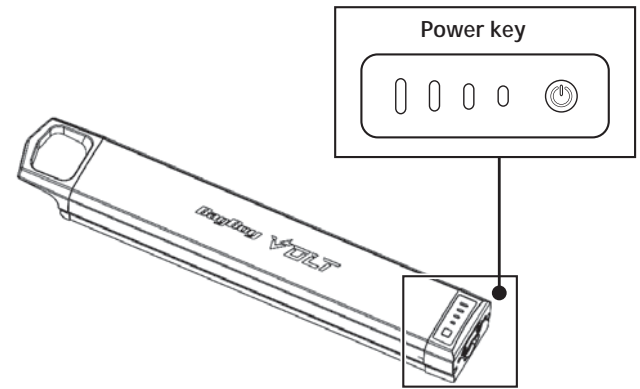

Press and hold the power key for 3 seconds to turn the battery ON/OFF. To check the power level, just tap the power key.

Notice : If you keep holding the power key for over 10 seconds, the battery will turn off.



100%-75% Power Level

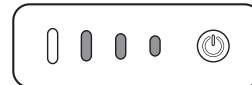

75%-50% Power Level

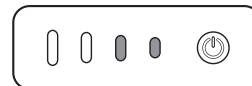

50%-25% Power Level

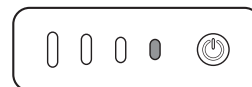

25%-10% Power Level

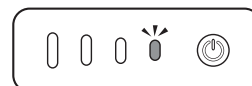

With flashing green LED light.
Under 10% Power Level

Charging Your Battery

We recommend fully charging your battery as soon as you open the box and after every round.

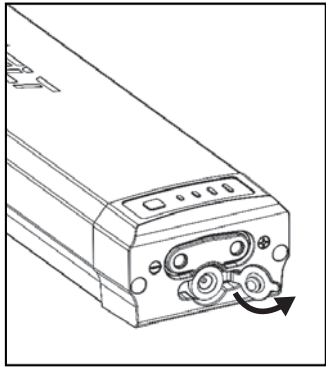

- Charge your battery with the enclosed charger.
- The LED power lights will flash when charging is in progress.
- There are lights on the battery to help you understand the charging progress.
- When fully charged, the 4 green LED power lights will be solid for a second, then turn off.
- A full charging process takes about 5 hours.

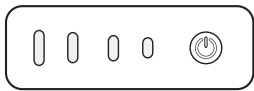

— Fully charged —
100% Power Level

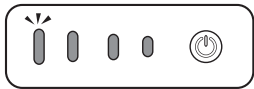

— Charging —
100%-75% Power Level

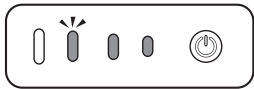

— Charging —
75%-50% Power Level

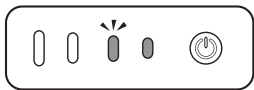

— Charging —
50%-25% Power Level

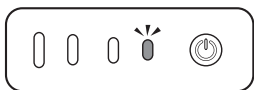

— Charging —
25%-0% Power Level

Operating & Display

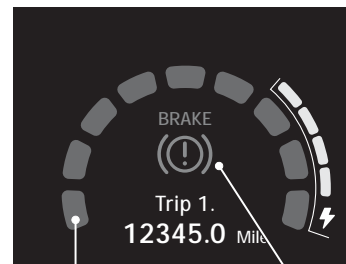
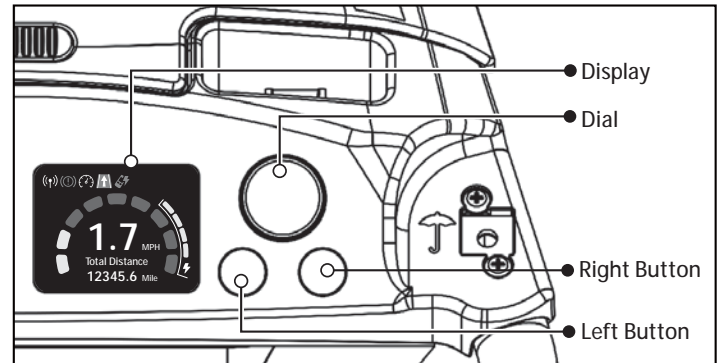

Speed Level

Brake Symbol

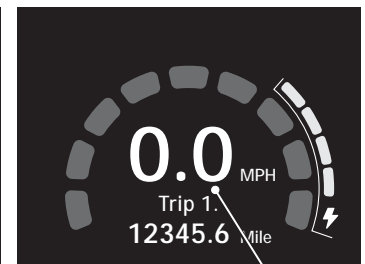

Cart Speed

Start VOLT

1. Connect the battery into the cart.
2. Press and hold the power button
 - *The brakes will be activated automatically every time when you turn on the power.
3. Turn the Dial to choose the desired speed level, then tap the Dial to start the carts movement.
 - *Turning the Dial clockwise will increase the speed while turning the Dial counter-clockwise will decrease the speed.
4. Tap the Dial to activate/release the brakes (stop).
5. The real-time speed of the cart will display on the middle of the screen.
6. The speed level (1-9) can be adjusted at any time by turning the Dial while moving.

Operating & Display

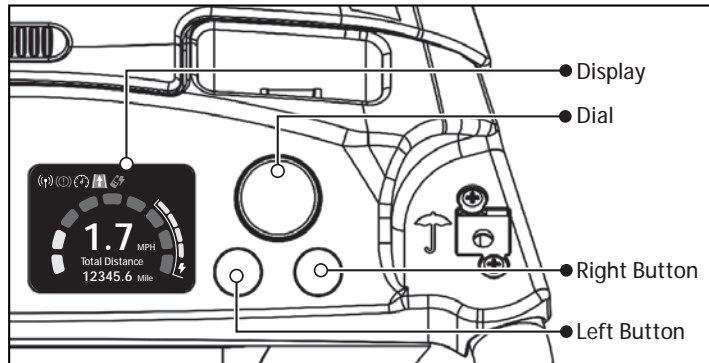

Distance Measuring & Setting

1. There are 3 distance measurement modes.
2. Press the Left Button to switch the modes - Total Distance / Trip 1 / Trip 2.
3. Press the Right Button to switch the Unit - MPH / KM.
4. Press and hold the Right Button for 3 seconds to reset the recording of Trip 1 & Trip 2.
5. Total Distance cannot be reset.

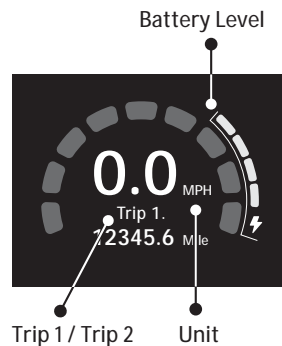

Battery level indicator

The battery level displays on the right side of the screen. Please always make sure the battery is fully charged before playing golf.

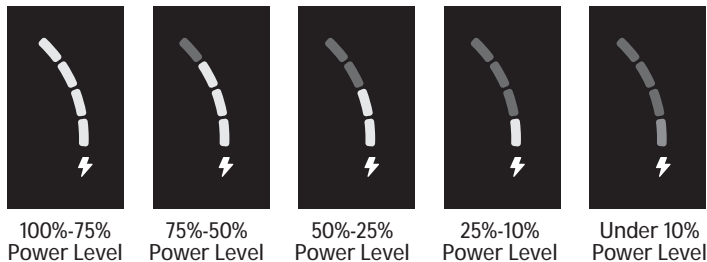

Distance Control

- Distance Control function can send the cart to the distance you desire.
- When the Volt is parked, press and hold Left Button for over 3 seconds to access the Distance Control setting page (fig.1). Pressing the Left Button will move back to the main page.
- The preset distance is 20 yards/meters. Turn the Dial to set the desired distance between 5-30 yards/meters.
- The speed level will be locked at level 4 in this mode, and the green indicator blocks will have a layer of slashes to indicate lock mode.
- Set the cart in the direction you desire, and then tap the Dial to send the Volt off to the desired distance. The remaining distance will display on the screen.
- The counting-icon will flash while moving. Another tap will stop the cart.
- "Gyroscopic Straight Line Tracker" will automatically turn on while moving.

*Read the description of "Gyroscopic Straight Line Tracker" on page 17.

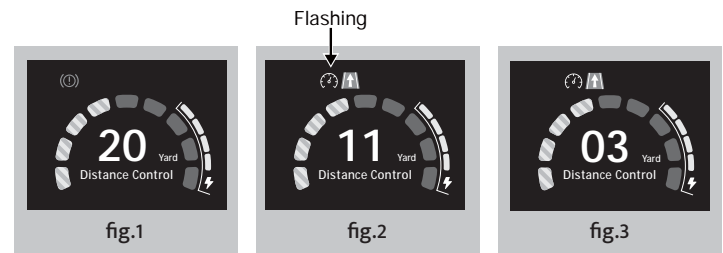

Free Run Control

- If you want to push the cart manually without the motors, you can turn the Dial counter-clockwise until the speed level is zero (or double-click the Dial) when the brakes are activated. Tap the Dial to release the brakes, and then you can push the cart freely.
- If you want to switch on the electricity-powered mode while pushing the cart, just turn the Dial, then the motors will be activated according to the current speed level.

Display – Icon Bar

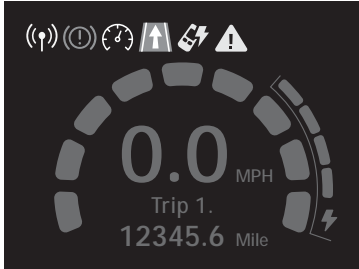

Icon Bar:

The icons of the cart status are displayed at the top of the screen. You can find the description in the table below.

icon		Meaning of the icon
	Signal	The cart receives the signal from the Remote.
	Stop	Brakes have been activated.
	Distance control	Moving by Distance Control function.
	Straight line walking	The "Gyroscopic Straight Line Tracker" is turned on.
	Remote Low Power	Remote needs to charge.

Display – System Info.

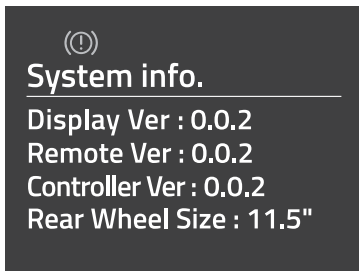

- Press and hold the Right Button while powering on the cart, and the cart will enter into the System information page.
- The cart will ignore remote control commands when in the Information page.

Display – Warning Info.

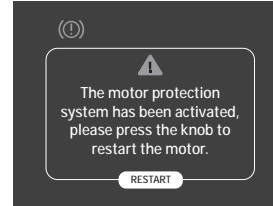

Motor Protection

- When the system detects the motor overload condition, it will display this notification and activate the Brakes.
- Press the Dial to close the notification, and move the cart to a flat surface to continue using it.
- If this prompt still shows up, please remove the battery from the cart and contact customer service for support.

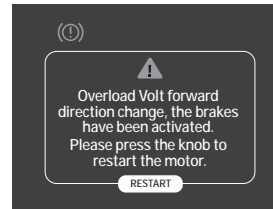

Angle Detection

- When the Gyroscopic Straight Line Tracker is activated, and the system is detecting that the Volt forward direction has changed to over 90 degrees, it will detect that the cart has potentially crashed, the brake will be activated at once to protect the motor system.
- Pressing the button to release it, you could continue to use the cart.
- If this prompt continues to display, please remove the battery from the cart and contact customer service for support.



Signal abnormality warning

- When this notification displays, the brakes will be activated.
- Please restart the power of the battery, then you can continue using it.
- If this prompt still shows up, please remove the battery from the cart and contact customer service for support.

Remote Control

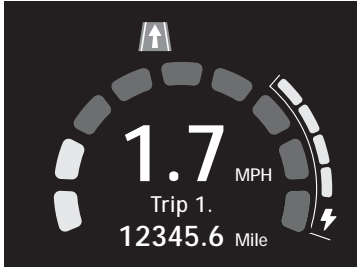

Gyroscopic Straight Line Tracker

- When you use the Remote Control to control the cart to move forward, the system will automatically turn on this function.
- It can ensure that the cart will move forward in the direction you expect and will not be offset by the direction of the turf.
- When this function turns on, the icon will display on the screen.
- If the cart hits an obstacle and turns too much, the brakes will be activated.

Remote Control

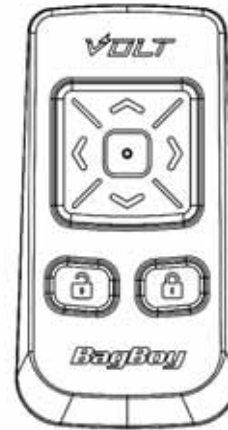

Charging

- Before using the Remote, please make sure that it is fully charged.
- The Remote contains a rechargeable lithium battery. Charge the Remote with the provided USB cable, and the charging port is located under the rubber cover located at the bottom of the remote.
- The blue LED flashes when charging is in progress, and it will remain solid when fully charged.
- When the battery level of the Remote is low, the blue LED and the red LED will start to flash at the same time. And the low battery icon of the remote will display on the display screen.
- When the battery is completely drained, no LED lights will light up when any button is pressed.
- The keypad will be locked while charging.
- A full charging process takes about 3 hours.

States	Description of LED lights
Low battery	The blue and red LED keep flashing.
Battery fully charged	The blue LED stays on.
Battery is charging	The blue LED keeps flashing.
Ready to pair	The blue LED and red LED flash separately.
Keypad is locked	The blue LED lights up while pressing any button.
Keypad is unlocked	The red LED lights up while pressing any button.

Remote Control

Operating Remote

1 Forward Button

- The starting speed is level 2. Each tap increases 1 speed level, maximum is level 9.
- Press and hold the Forward Button to speed up the motor quickly. (accelerate to level 9 in 3 seconds)

2 Down Button

- When the brakes is activated, press and hold Down Button to move the cart in reverse.
- While moving forward, every time you tap the Down Button, the speed will be reduced by 1level, and the minimum speed is level 1

3&4 Left / Right Button

- Tap the Left / Right Button, then the cart will turn slightly and continue to move forward. (no matter if the cart is moving or not)
- Press and hold the Left / Right Button, then the cart will keep turning left / right until release the button.

5 Stop Button

- You can stop the cart by tapping the button in every case.
- When the motor protection is activated, press the Stop Button to release from this, or you may press the Dial on the cart console.
- * Read the description of the motor protection on "Warming Info" page (p.16).

6 Unlock Button

- If the remote control keys are locked, press the Unlock Button to unlock the keypads.
- Press any button when the keypad unlocked, the blue LED will light up.

7 Lock Button

- Press the Lock Button to limit and prevent unexpected control.
- Press any button when the keypad locked, the red LED will light up.

8 Charging Port

- USB-C port
- The keypad will be locked while charging

* The cart will automatically stop after walking 100 yards – unless it receives a new command from the remote.

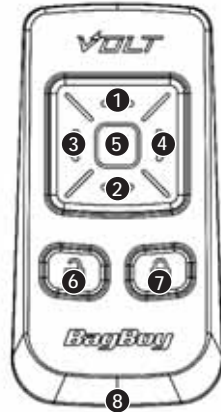

Pairing Your Remote

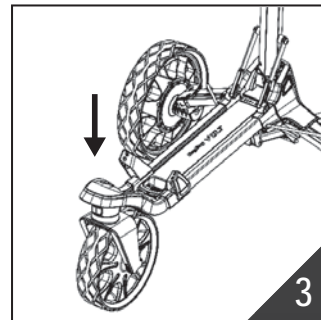
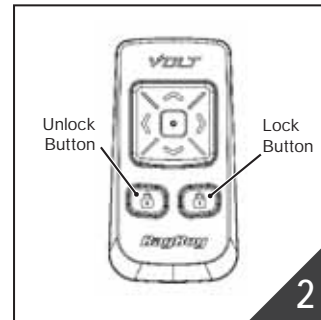
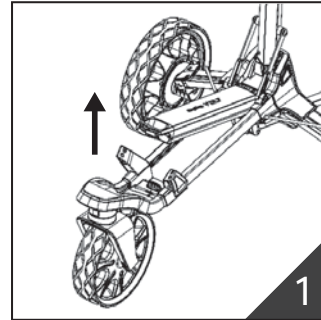

1. Turned off the power of the cart. You can remove the battery from the cart or turn off the power of the battery.

2. Press and hold the Lock & Unlock buttons on the remote at the same time until the blue and red LED blink alternately. Then the remote will enter into the pairing mode and continue sending the pairing signal for 60 seconds.

3. Turn on the power of the cart.

4. The cart will search for the pairing signal from the remote for 5 seconds automatically after switched on. When the screen displays " Found a New Remote " as Pic.4, It means the pairing is complete.

5. Then the screen will automatically enter into the main page as Pic. 5

* The keypad of the Remote will be locked during the pairing mode except for the Unlock Button.

* The remote control will automatically exit the pairing mode after 60 seconds, or press and hold the Unlock Button for 3 seconds.

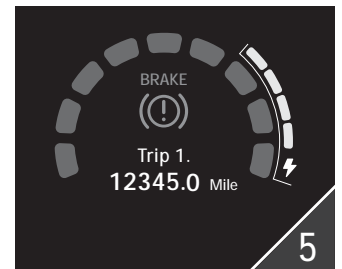

FCC Compliance Statement

- This device complies with part 15 of the FCC Rules. Operation is subject to the following two conditions: (1) this device may not cause harmful interference, and (2) this device must accept any interference received, including interference that may cause undesired operation.
- This Transmitter must not be co-located or operating in conjunction with any other antenna or transmitter.
- Any changes or modifications not expressly approved by Bag Boy for compliance could void the user's authority to operate this equipment.
- This equipment has been tested and found to comply with the limits for a Class B digital device, pursuant to part 15 of the FCC Rules. These limits are designed to provide reasonable protection against harmful interference in a residential installation.
- This equipment generates, uses and can radiate radio frequency energy and, if not installed and used in accordance with the Instructions, may cause harmful interference to radio communications. However, there is no guarantee that interference will not occur in a particular installation. If this equipment does cause harmful interference to radio or television reception, which can be determined by turning the equipment off and on, the user is encouraged to try to correct the interference by one or more of the following measures:
 - Reorient or relocate the receiving antenna.
 - Increase the separation between the equipment and receiver.
 - Connect the equipment into an outlet on a circuit different from that to which the receiver is connected.
 - Consult the dealer or an experienced radio/TV technician for help.
- This product has demonstrated EMC compliance under conditions that included the use of compliant peripheral devices and shielded cables between system components. It is important that you use compliant peripheral devices and shielded cables between system components to reduce the possibility of causing interference to radios, televisions, and other electronic devices.
- FCC Radiation Exposure Statement:
 - This equipment complies with FCC RF radiation exposure limits set forth for an uncontrolled environment.
 - This equipment should be installed and operated with a minimum distance of 20 centimeters between the radiator and your body.
- Responsible party (contact for FCC matters only):

Dynamic Brands
2701 Emerywood Pkwy., Ste. 200
Richmond, VA 23294
USA
(804) 726-1343



Battery Care & Safety

- Always charge the battery as soon as possible after each use. Low battery power will affect the use, especially in the low-temperature environment, timely charging is good for the battery life.
- Please make sure that the battery and charger are provided by Bag Boy. The battery charger is specially designed according to the requirements of the battery manufacturer. Lithium battery chargers must not be used to charge any other batteries and should only be used with Bag Boy lithium batteries.
- The vehicle should avoid climbing with high speed as far as possible, when the battery is low and the power lamp is 2 grids or less.
- If the battery will not be used for some time, remove it from the cart and store it in a cool, dry location with an ambient temperature of 5 °C to 25 °C (41 °F to 77 °F). Avoid hot or extremely cold locations.
- Please charge the battery within 24 hours after use, especially when the power indicator lamp is at 1 grid and out of power.
- During long periods of no usage, charge the battery once every 3 months before returning it to a cool location for storage.
- Do not use the battery at ambient temperatures below -15 °C (5 °F) or above 50 °C (122 °F). Failure to observe this precaution could damage the battery or impair its performance. Charge the battery indoors at ambient temperatures of 5 °C–40 °C (41 °F–104 °F). The battery will not charge if its temperature is below 0 °C (32 °F) or above 50 °C (122 °F).
- Please use the battery on the cart specified or allowed by the manufacturer, otherwise the battery may be damaged or dangerous due to the mismatch of specifications.
- Batteries may be hot after use. Observe due caution when removing batteries from the cart.

Battery Care & Safety

- The battery charger should only be opened and serviced by authorized personnel. Unauthorized opening or repair will void your warranty. Risk of electrical shock or fire.
- Do not strike, throw or trample the battery.
- Do not use and leave the battery near a heat source such as fire or heater.
- Do not connect the charger if the charge port, charge cable or the battery is wet.
- Do not splash or immerse the battery in liquids.
- If the battery gives off an odor, generates heat, or in any way appear abnormal during usage, recharging or storage, immediately remove it from the cart and stop using it.
- Never use the battery if the case or terminals are damaged.
- Water damage will void the warranty
- The battery is a sealed unit. In the unlikely event liquid leaks from the battery, do not touch the liquid as it may cause irritation or burns.

Follow these precautions:

- Skin contact: wash with soap and water.
- Inhalation: Expose to fresh air and seek medical advice.
- Eye contact: Immediately wash with water at least 15 minutes. Seeking medical attention.
- Disposal: Wearing gloves to handle the battery and dispose of immediately, contact your local council or recycling center.